

Module Picture

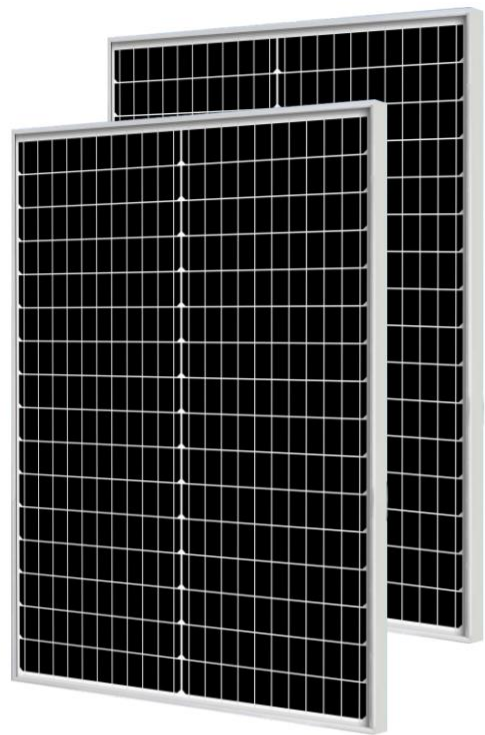

SP040M-32

Comprehensive Certificates

- IEC61215, IEC61730
- ISO9001:2015 Quality management systems
- ISO45001: Environmental management systems
- ISO45001:2018 Occupational health and safety management systems



Mechanical Diagrams

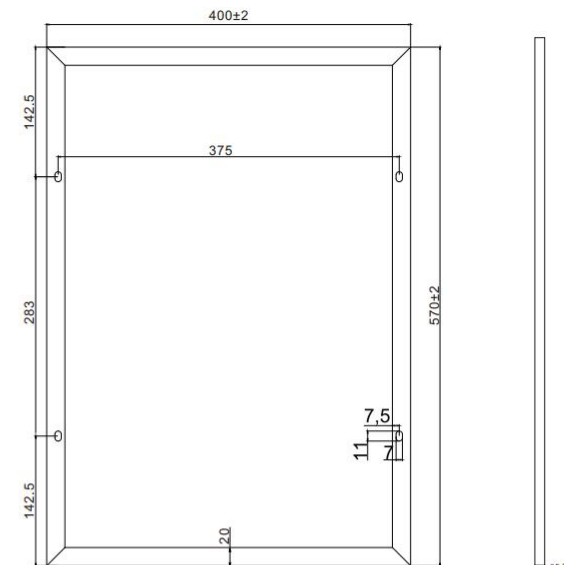
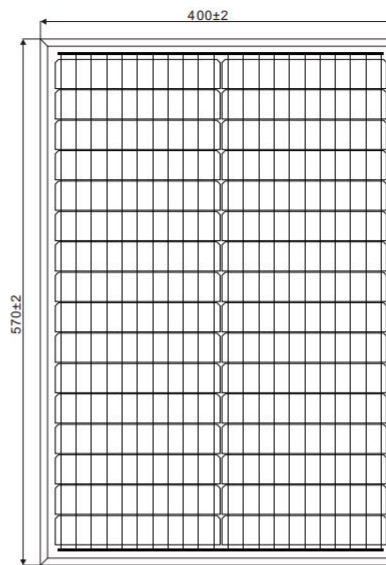

PS: Frame color and cable length can be customized

Electrical Parameters at (STC)

Module	Power (W)	Module Efficiency(%)	Voltage at Pmax(Vmp)	Current at Pmax(Imp)	Open Circuit Voltage(Voc)	Short Circuit Current(Isc)	Power Tolerance(w)
SP040M	40W	17.50%	18.24	2.19	21.80	2.39	±3%

Characteristics

Current Voltage Curve SP040M/32

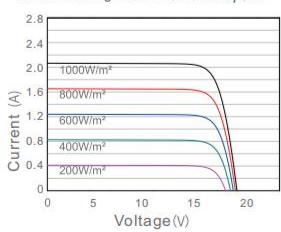

Power Voltage Curve SP040M/32

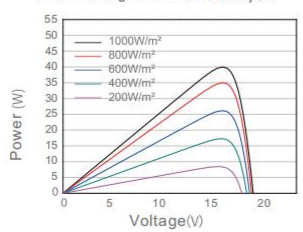

Current Voltage Curve SP040M/32

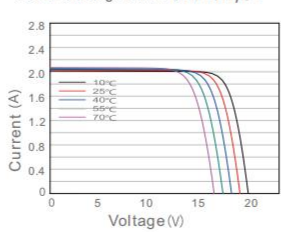

Mechanical Parameters	
Solar Cell(Type/Size)	MONO(182mm)
Solar Cells Number	32Pcs(2x16)
Dimension	570x400x25mm
Weight	2.80Kg/Pcs
Tempered Glass	3.2 mm High Permeability Coated
Frame	Anodized aluminum alloy
Junction Box	IP67, 0* bypass diode
Cable	//
Connector	Original MC4/Compatible MC4
Mechanical Load	Front 5400PA/back 2400PA

Packing	
Module Type	SP040M-32
Carton Size	600x430x170mm
Number	5Pcs/Ctn
Weight	15Kg/Ctn
Volume	0.044 Cbm/Ctn
20GP Container	3180Pcs
40HQ Container	7730Pcs

- STC: ☀️ Light intensity 1000W/m₂ 🔋 Battery temperature: 25°C ☁️ atmosphere quality=15
- NOCT: ☀️ Light intensity 800W/m₂ 🔋 Battery temperature: 20°C ☁️ atmosphere quality=15 🌀 wind velocity 1m/s